



Insulated Curb

SPECIFICATIONS

Insulated Curbs as manufactured by Lubbock Skylight Manufacturing [(800) 390-2301.] Curbs shall be 6", 9" or 12" tall with 1 ½" Dow® polystyrene insulation, wood nailer and 0.040" (6063-T5) extruded aluminum with welded corners. Finish shall be Mill.

ALL UNITS ARE GUARANTEED AGAINST DEFECTIVE WORKMANSHIP AND MATERIAL.

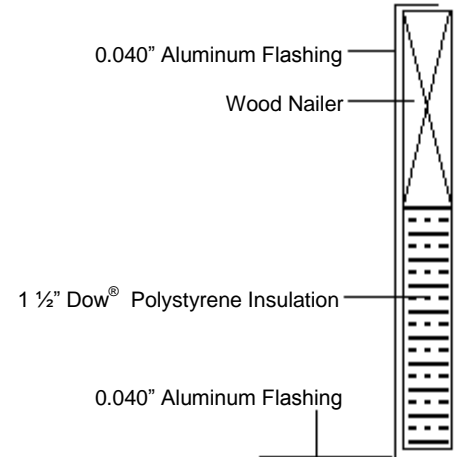

THIS FORM IS PRIMARILY FOR A LARGER VIEW OF THE INSULATED CURB. FOR INSULATED CURBS WITH A CURB MOUNT SKYLIGHT, PLEASE REFER TO "CURB MOUNT WITH INSULATED CURB" SPEC SHEET. WE NEED ROUGH OPENING MEASUREMENTS WHEN WE ARE MAKING THE CURBS.